

## Now available in LED!

### APPLICATIONS

The ARWS Recessed Series combines soft open template shapes with energy efficient fluorescent lighting providing a new and unique view of the ceiling plane. New and existing open spaces can be divided and visual attention can be directed to areas of the room. Commercial logos and company trademarks can be created with strategic placement on the ceiling. See Custom/Special Applications Section.

The ARWS Recessed Series provides new visual options to the ceiling design process. The product line is designed to create interest in the ceiling area and to provide a fixture series that is cost effective and energy compliant.

### CONSTRUCTION

Precision formed 20 gauge CRS body. The rigid body design is compatible with most suspended ceiling systems.

All steel parts are covered by Apollo Lighting's 10 Year Limited Warranty. Refer to Warranty Section for details.

### FINISH

The ARWS Recessed Series standard paint finish of polyester powder coat is applied after a five stage rust inhibitive process. Gloss white body and templates are standard. Custom colors and finishes; please consult factory.

### ELECTRICAL

High efficiency electronic ballast is standard. A wide range of dimming, daylight harvesting, automated building control, occupancy control and emergency back up systems can be specified to meet today's energy code requirements. Refer to Ordering Information Options.

Standard quick connect access plate is provided with UL required power disconnect provided for each electronic ballast. All luminaires are UL Listed.

## ORDERING INFORMATION

Series	Size	Lamps	Type	Shielding	Layout	Mounting	Voltage	Options
ARWSS								
ARWSS	1 (1X4)	2	T8	OL	5 (1X4)	G	1	F
		3	T5	Opal Lens	1 (2X2)	9/16" Grid	(120v)	Fuse
	2 (2X2)	4	T5HO	PL	2 (2X2)	F	U	EM
			BIAX	Pattern #12	4 (2X2)	Sheetrock Flange	Universal	Emergency
4 (2X4)			LED	Prismatic	1L (2X4)	MP	(120-277)	Ballast
			P95	Pattern #95	4L (2X4)	Metal Pan Ceiling	2	Dimming &
				Prismatic	2L (2X4)	Consult factory	(277v)	controls; see
					Custom patterns.	for mounting options.		Accessory
				Consult factory.			Section.	

Now available in LED!

# A R W S S

Type
Project

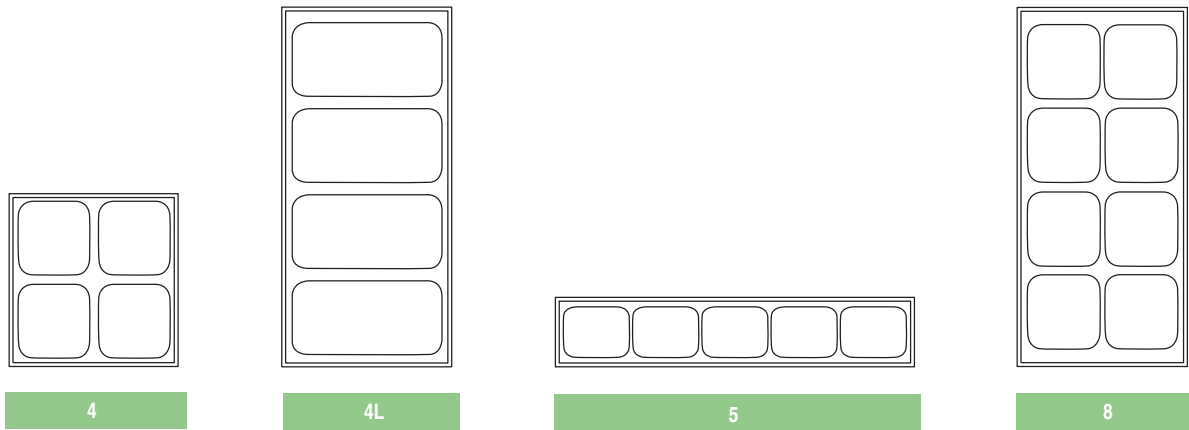
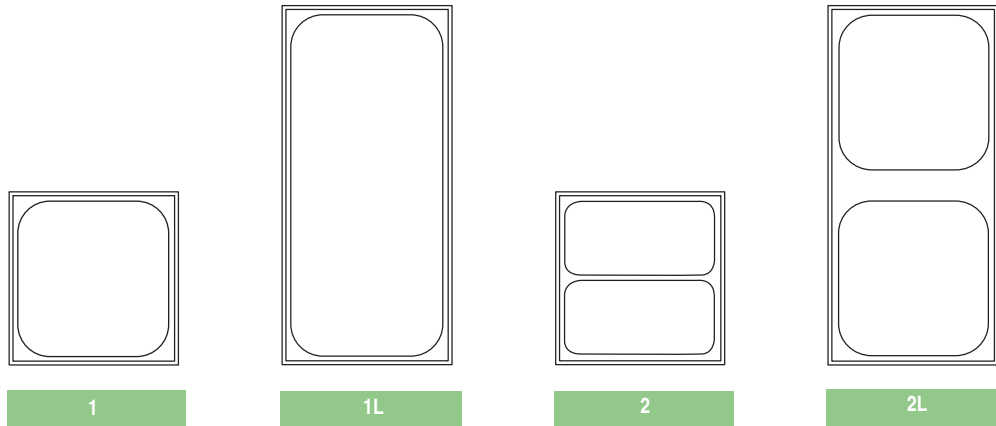
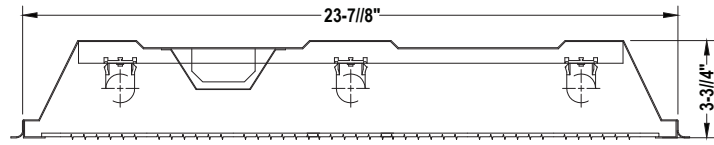

**Note:** Apollo Lighting reserves the right to make any design change for continuous improvement which will not change the overall appearance or decrease performance. All ceilings are to be adequately reinforced by others. All fixtures are to be wired by a licensed electrician only. The information contained herein is the sole property of Apollo Lighting and may not be used without prior written consent.



**APOLLO LIGHTING** creative lighting solutions since 1950  
 212 S. 12th Avenue • Mount Vernon, NY 10550  
 1-866-300-1294 • Phone: 914.664.3600 • Fax: 914.664.6091  
 info@apollolighting.net • www.apollolighting.net



Now available in LED!